

Please read these instructions carefully and store in a safe place for future reference.

FLYPOD™

As part of the P+L brand of insect control products, **Flypod®** is an easy to service and highly effective decorative insect control unit for use within front of house applications. **Flypod®** utilises a highly effective UV tube and is designed for use with a high specification glupac™ glueboard. Patented technology ensures the user doesn't come into contact with caught flies.

Contents of package

- 1 x Flypod® flykiller
- 1 x glupac™ pheromone impregnated glueboard
- 1 x PL-L compact 18W tube

WARNING - THIS APPLIANCE MUST BE EARTHED

INSECT CONTROL PRODUCTS

Flypod® utilises a high powered ultra violet tube to attract flying insects and retains the caught insects on a pheromone impregnated glueboard for inspection or hygienic disposal.

POSITIONING

THIS UNIT IS FOR INDOOR USE ONLY.

Flypod® should ideally be positioned in the darkest place within the area to be protected and is supplied with a two meter mains lead. Do not position the unit close to windows, skylights or other sources of light, or where it may be obscured by furniture, doors or other obstacles. Ideally, **Flypod®** units should be visible from every part of the area to be protected.

INSTALLATION

PRIOR TO INSTALLATION, ENSURE THE POWER SUPPLY OF YOUR MAINS OUTLET CORRESPONDS TO THAT MARKED ON THE SPECIFICATION LABEL FOUND ON THE FLYKILLER.

Once correctly positioned on a level, horizontal location, fit the glupac™ glueboard in position as described in the glueboard replacement section of this document. **Flypod®** has a plug fitted to the mains lead and once installed in position, should be plugged into the nearest mains outlet.

WARNING - THIS APPLIANCE MUST BE EARTHED

USING FLYPOD®

Flypod® should ideally be in operation for 24 hours a day, ensuring your premises are kept free of flying insects. Insects are most attracted to **Flypod®** at night when there is no competition from daylight or other light sources.

CLEANING

ENSURE THAT THE FLYING INSECT KILLER IS DISCONNECTED FROM THE MAINS BEFORE CLEANING.

It is recommended that cleaning is carried out regularly when the glueboard is replaced. Once the glueboard is removed, the unit should be thoroughly wiped down with a damp cloth, removing any build up of dirt. Ensure the unit is completely dry before reconnecting it to the power supply.

GUARANTEE

Flypod® has a two year guarantee and if maintained as recommended in these instructions should continue to work for many years.* Use of non-approved consumables may invalidate the guarantee. Ensure genuine glupac™ glueboards are used in conjunction with this product.

*Excludes tubes, glueboards and starters. Does not cover breakdown due to misuse, incorrect operation or use in an incorrect application.

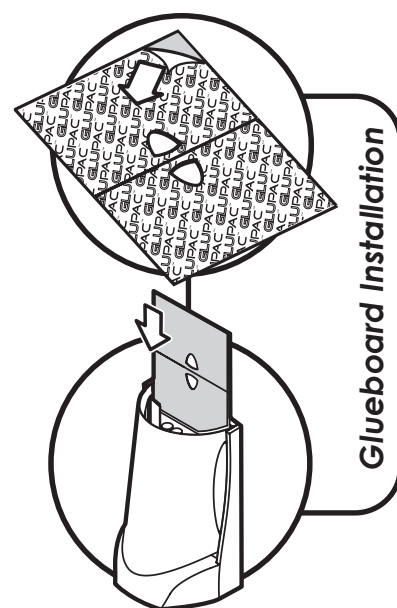

GLUEBOARD REPLACEMENT

BEFORE REPLACING THE GLUEBOARD, ALWAYS ENSURE THAT THE UNIT IS DISCONNECTED FROM THE MAINS SUPPLY.

The glueboard should be replaced every month with a genuine glupac™ glueboard. Use of non-approved glueboards may invalidate your guarantee.

To replace the glueboard...

1. Position the **Flypod®** so the back is facing you.
2. Using one hand to support the unit use your thumb and forefinger of your other hand to gently pull the used glueboard out through the slot in the back of the unit.
3. Once free from the unit, dispose of the used glueboard hygienically.
4. Remove the protective release paper from the new glupac™ glueboard.
5. Slide a new glueboard into position as shown on the first page of this instruction sheet.

Always ensure the selected genuine glupac™ glueboards are compatible with your unit, available from your PCO or P+L Systems Ltd.

TUBE REPLACEMENT

BEFORE REPLACING THE TUBE, ALWAYS ENSURE THAT THE UNIT IS DISCONNECTED FROM THE MAINS SUPPLY.

To ensure the efficiency of **Flypod®** in catching flying insects, the UV tube should be replaced annually. After twelve months the phosphor coating that emits the correct wavelength of UV light has burnt away and the UV output is diminished substantially.

To replace the UV tube...

1. Pull the tube gently from the tube holder until it un-clips.
2. Gently rotate the tube until it becomes free from the tube support.
3. Reverse the process with the replacement tube.

STARTER REPLACEMENT

BEFORE REPLACING THE STARTER, ALWAYS ENSURE THAT THE UNIT IS DISCONNECTED FROM THE MAINS SUPPLY.

The starter provides an extra spark to initially light the UV tube. The starter wears out and should be replaced at the same intervals as the UV tube.

To replace the starter...

1. Remove the glueboard from the units described above.
2. Rotate the starter anti-clockwise.
3. Pull the starter free from the unit.

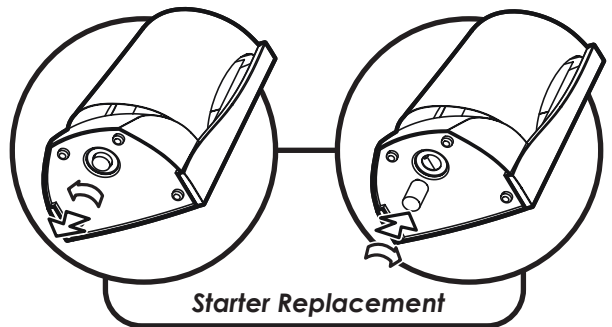
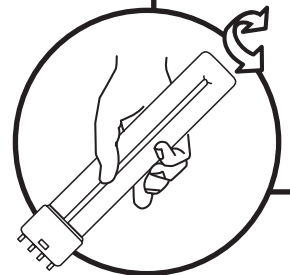
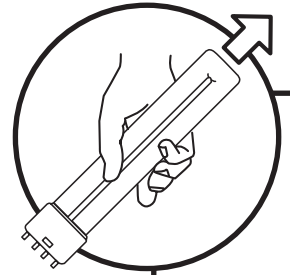
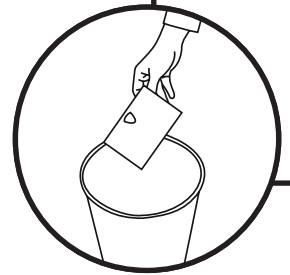
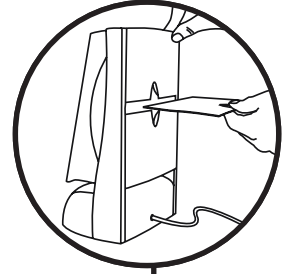
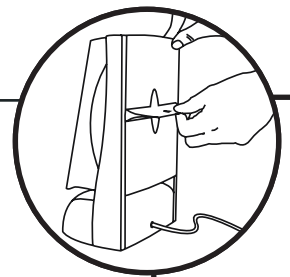

Glueboard Replacement

Tube Replacement

Starter Replacement

SPECIFICATION / REPLACEMENT PARTS

Unit	Flypod
Voltage	230V - 50Hz
Dimensions (mm)	190 x 300 x 140
Coverage	50m ²
Weight	2kg
Light Output	18W
Tubes	1 x I815
Starter	1 x I154
Glueboard X6	INF252