

Satalite™

Decorative Glueboard Insect Control

Please read these instructions carefully and store in a safe place for future reference.

SATALITE™

As part of the P+L brand of insect control products, **Satalite™** is designed to be the most effective range of front of house glueboard insect control units on the market. **Satalite™** utilises highly effective UV tubes and is designed for use with a high specification glupac™ glueboard. Two sizes of unit are available, 18W and 30W, both of which can be mounted either horizontally or vertically.

Contents of package

- 1 x Satalite flykiller
- 1 x glupac™ pheromone impregnated glueboard
- 2 x Screws and wall plugs
- 1 x PL-L compact 18W tube (fitted)
- or
- 2 x 15W High powered insect attractive UV tubes (fitted)

WARNING - THIS APPLIANCE MUST BE EARTHED

INSECT CONTROL PRODUCTS

Satalite™ utilises high powered ultra violet tubes to attract flying insects and retains the caught insects on a pheromone impregnated glueboard for inspection or hygienic disposal.

POSITIONING

THIS UNIT IS FOR INDOOR USE ONLY.

Satalite™ should ideally be fixed around two meters above the ground, preferably in the darkest place within the area to be protected and is supplied with a two meter mains lead. Do not position the unit close to windows, skylights or other sources of light, or where it may be obscured by furniture, doors or other obstacles. Ideally, **Satalite™** units should be visible from every part of the area to be protected.

INSTALLATION

PRIOR TO INSTALLATION, ENSURE THE POWER SUPPLY OF YOUR MAINS OUTLET CORRESPONDS TO THAT MARKED ON THE SPECIFICATION LABEL FOUND ON THE FLYKILLER.

To ensure **Satalite™** reaches you in perfect condition, a protective film covers the aluminium backplate. Remove this film before use.

Satalite™ should be fixed to the wall with the supplied wall plugs and screws and can be mounted either horizontally or vertically. Once installed in position, fit the glupac™ glueboard in position as described in the glueboard replacement section of this document. **Satalite™** has a plug fitted to the mains lead and once installed in position, should be plugged into the nearest mains outlet.

WARNING - THIS APPLIANCE MUST BE EARTHED

USING SATALITE™

Satalite™ should ideally be in operation for 24 hours a day, ensuring your premises are kept free of flying insects. Insects are most attracted to **Satalite™** units at night when there is no competition from daylight or other light sources.

CLEANING

ENSURE THAT THE FLYING INSECT KILLER IS DISCONNECTED FROM THE MAINS BEFORE CLEANING.

It is recommended that cleaning is carried out regularly when the glueboard is replaced. Once the glueboard is removed, the unit should be thoroughly wiped down with a damp cloth, removing any build up of dirt. Ensure the unit is completely dry before reconnecting it to the power supply.

GUARANTEE

Satalite™ has a two year guarantee and if maintained as recommended in these instructions should continue to work for many years.* Use of non-approved consumables may invalidate the guarantee. Ensure genuine glupac™ glueboards are used in conjunction with this product.

*Excludes tubes, glueboards and starters. Does not cover breakdown due to misuse, incorrect operation or use in an incorrect application.

WALL MOUNTING

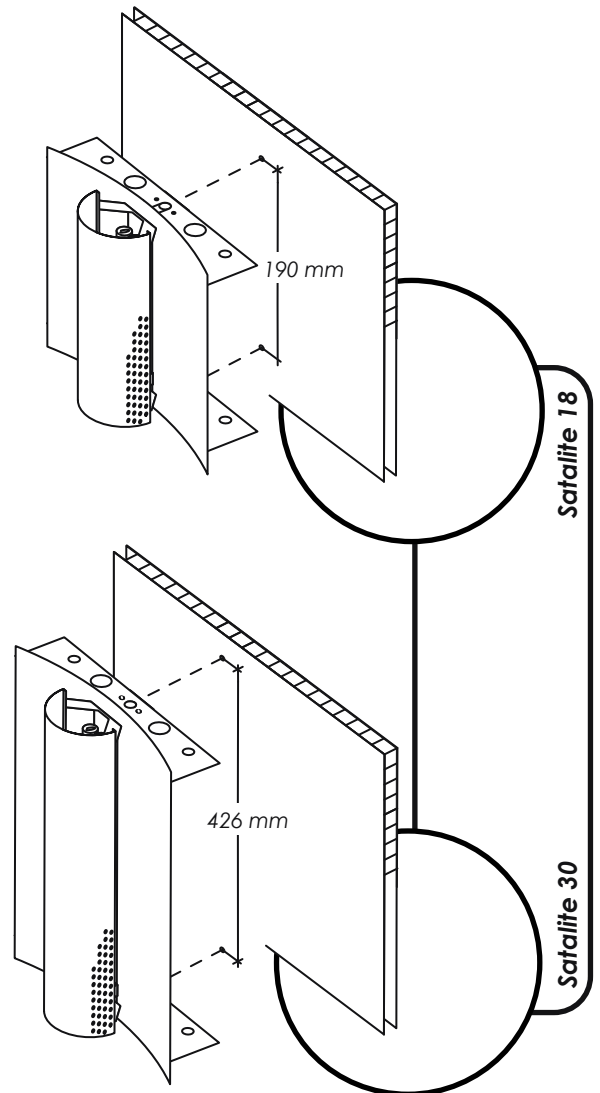

GLUEBOARD REPLACEMENT

BEFORE REPLACING THE GLUEBOARD, ALWAYS ENSURE THAT THE UNIT IS DISCONNECTED FROM THE MAINS SUPPLY.

The glueboard should be replaced every month with a genuine glupac™ glueboard. Use of non-approved glueboards may invalidate your guarantee.

To replace the glueboard...

1. Remove the used glupac™ glueboard by simply sliding it out of the top of the front reflector and either retain for insect evaluation or dispose of it hygienically.
2. Remove the protective release paper from the new glupac™ glueboard.
3. Slowly slide the new glueboard into position along the two runners with the adhesive side facing the tube(s).

Always ensure the selected genuine glupac™ glueboards are compatible with your unit, available from your PCO or P+L Systems Ltd.

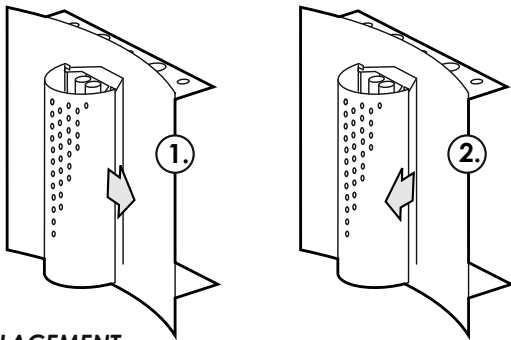

TUBE REPLACEMENT

BEFORE REPLACING THE TUBE(S), ALWAYS ENSURE THAT THE UNIT IS DISCONNECTED FROM THE MAINS SUPPLY.

To ensure the efficiency of Satalite™ in catching flying insects, the UV tube(s) should be replaced annually. After twelve months the phosphor coating that emits the correct wavelength of UV light has burnt away and the UV output is diminished substantially.

To replace the UV tube(s) first remove the front reflector as shown in the above diagrams. Then remove the tube(s) by...

- Satalite 18
1. Pull the tube gently from the tube holder until it un-clips.
 2. Gently rotate the tube until it becomes free from the tube support.
 3. Reverse the process with the replacement tube.
 4. Dispose of the used UV tube(s) in conjunction with local WEEE regulations.

- Satalite 30
1. Rotate the tube through 90 degrees.
 2. Gently pull the tube away from the unit.
 3. Reverse the process with the replacement tube.
 4. Dispose of the used UV tube(s) in conjunction with local WEEE regulations.

SPECIFICATION / REPLACEMENT PARTS

Unit	Satalite 18	Unit	Satalite 30
Voltage	230V ~ 50Hz	Voltage	230V ~ 50Hz
Dimensions(mm)	300 x 300 x 110	Dimensions(mm)	300 x 550 x 130
Coverage	30 Sq. Meters	Coverage	60 Sq. Meters
Weight	1.5 Kg	Weight	2.5 Kg
Light Output	18W	Light Output	30W
Tube	1 x 1815	Tubes	2 x 1616
Glueboards (x6)	INL147	Glueboards (x6)	INL161
Wall Fixing points	190mm	Wall Fixing Points	426mm

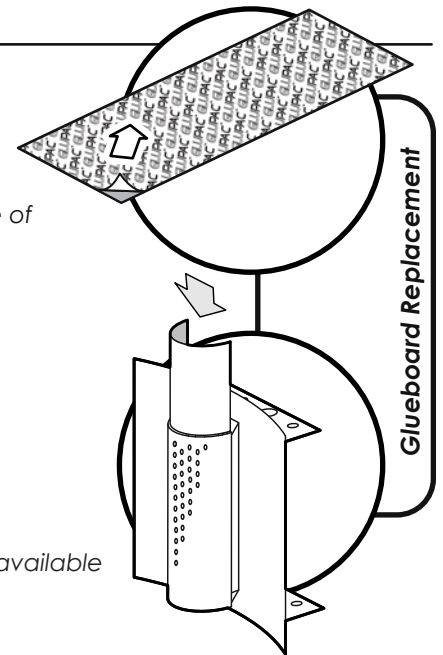

Glueboard Replacement

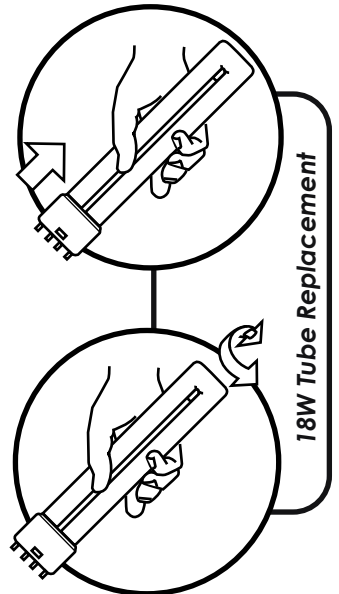

18W Tube Replacement

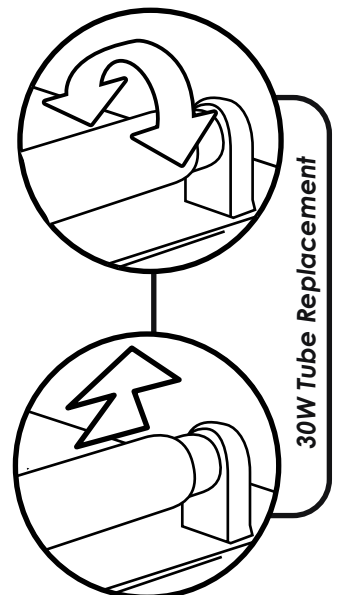

30W Tube Replacement