

Model 0391-(n)*



EZFILL™ SOAP DISPENSER
AUTOMATIC DECK MOUNTED
SOAP DISPENSER FOR
STANDALONE USE
INSTALLATION AND MAINTENANCE GUIDE

TABLE OF CONTENTS

2	SUFFIX CODE INDEX AND APPLICATIONS
3	PRE-INSTALLATION INFORMATION
4	PACK CONTENTS
5	TECHNICAL DATA
6-8	INSTALLATION
9	FILLING THE BOTTLE AND PRIMING THE SOAP DISPENSER
10	BATTERY REPLACEMENT INSTRUCTIONS
10	MAINTENANCE
11	TROUBLESHOOTING
12	SPARE PARTS LIST
12	WARRANTY
14-15	EZ FILL™ REMOTE CONTROL

Unit Install Date _____

Unit Location in Facility _____

Unit S/N (From Label) _____

Supplied By _____

Original PO No. _____

ASI Order No. _____

*SUFFIX CODE INDEX AND APPLICATION

Schedule of Model N° Suffix Codes to replace (n) in Model N° and Application	
Model N° Suffix	Service Application
1A	Universal Model, Battery Operation
1AC	USA/UK/EU Interchangeable Plug Model, AC Adapter Operation
3AC	AU Model, AC Adapter Operation
6-1A	Universal Model, Battery Operation, Six Pack
6-1AC	USA/UK/EU Interchangeable Plug Model, AC Adapter Operation, Six Pack
6-3AC	AU Model, AC Adapter Operation, Six Pack

Space Provided For Owner Notes

PRE-INSTALLATION INFORMATION

CHECK CONTENTS

Separate all parts from the packaging and check each part with the PACK CONTENTS section.

Make sure all parts are received and separated before discarding any packaging material.

If any parts are missing, do not attempt to install the system until you obtain the missing parts.

IMPORTANT

Ensure there is adequate space and clearance under the vanity to accommodate the SD Mounting Shank and Basin Nut in the desired location before drilling the hole in the counter top.

Ensure there is adequate space to place the Pump, and Bottle Support Bracket within reach of the Com Cable from the SD Shank.

Keep in mind that the location of the user hands, while using the faucet nearby, should not interfere with the soap dispenser sensor detection area.

CAUTION

Do not install the soap dispensers facing a mirror or any other electronic system operated by an infrared sensor.

To prevent reflection problems, it is recommended to keep a minimum distance of 5' (1.5M) between the soap dispenser sensor and any other directly facing objects.

PACK CONTENTS

EZFILL™ SOAP DISPENSER 0391-(n)

Identify the items and confirm that parts are included.

Automatic SD Body and vanity mounting hardware with power cord, Com Cable w/inline plug connector and black soap supply tube 1/4" dia. (Ø6) Nylon flex 36" (914) long with connector.

EZFILL™ pump assembly with bottle support wall bracket, Com Cable w/inline socket connector, soap supply tube and mounting hardware.

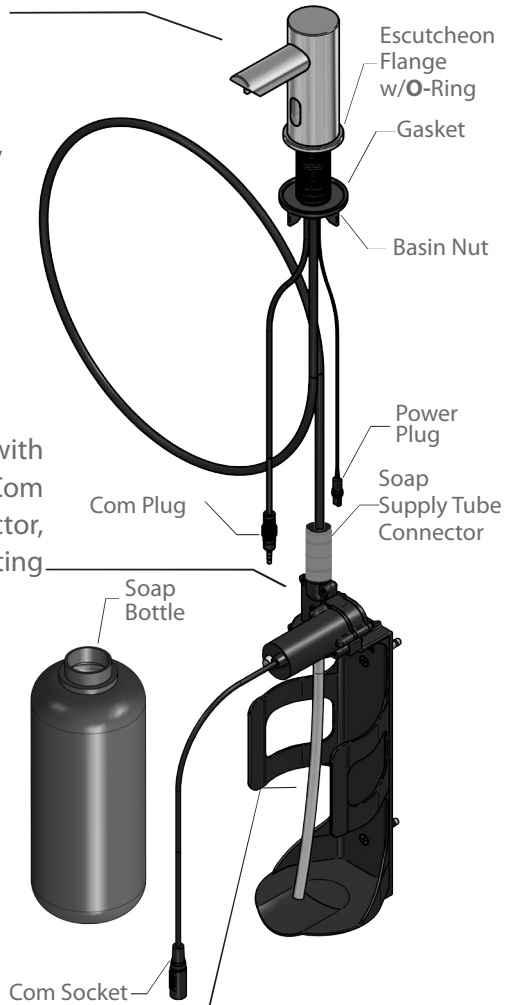

Clear 5/16" dia. (Ø8) Flex tube 9" (230) Supplied permanently attached to pump housing.

Power Supply Option



Battery Box
6Dx1.5V=9V

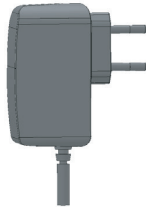

Plug Adapter
configuration per
model

One (1) ONLY either per model

Transformer
12V from 100~240 VAC

TECHNICAL DATA

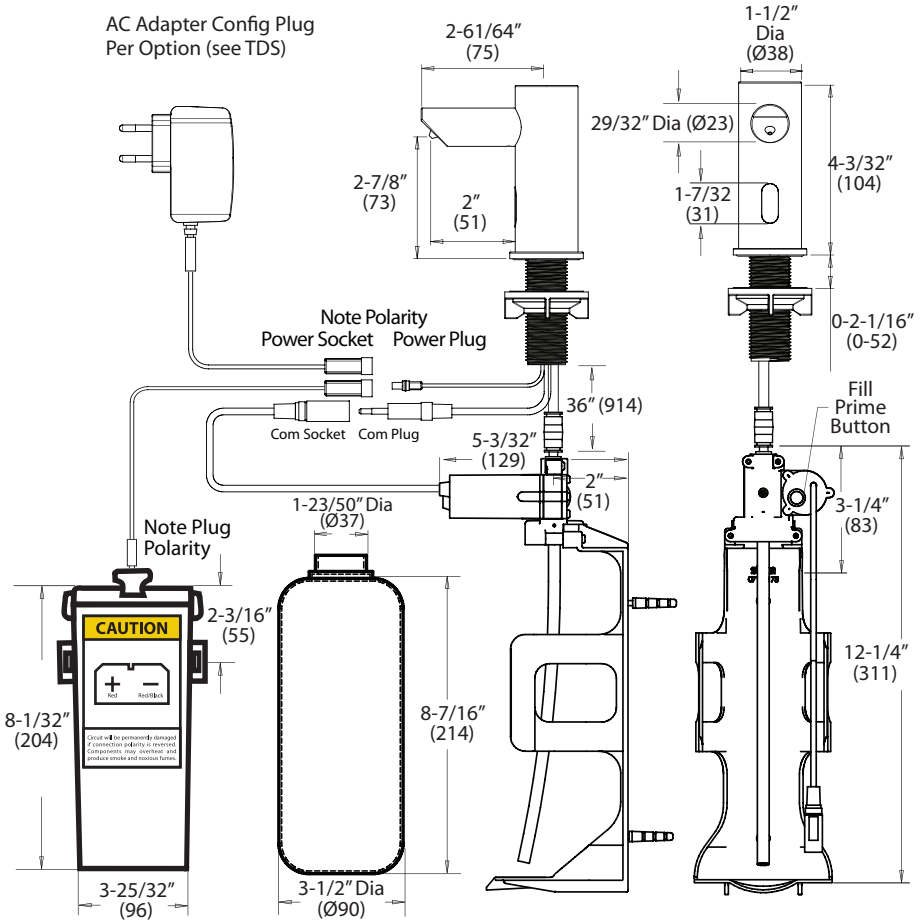

Battery Box w/Extension Cable
per Model Option (see TDS)

Model 0391-(n) EZFILL™ Soap Dispenser and Soap Pump for standalone operation with 33.8oz (1L) bottle

Soap Viscosity
100-3800cP (mPa·s)

Soap pH
5.5 – 8.5

Soap Type
clear liquid no abrasives

INSTALLATION

STEP 1 - INSTALLING THE EZFILL™ SOAP DISPENSING SYSTEM SOAP DISPENSER

1

Drill a hole in the counter top at the designated location.
Remove and retain the basin nut and the gasket from the base of the soap dispenser body, sliding completely over and off the soap tube, Com and Power Cables.

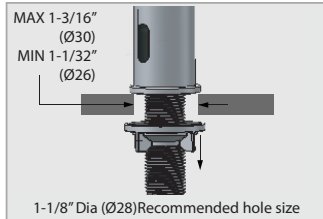

2

Place the soap dispenser shank through the escutcheon flange (with O-ring down) into the hole in the counter top.
Slide the gasket, disk and nut over the black soap tube and both cables and thread onto the shank and secure it to deck underside.

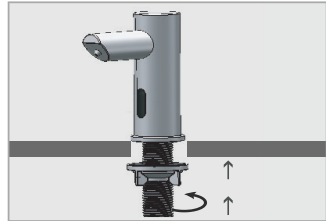

3

Black Nylon 1/4" dia. (Ø6) tube 36" (914) long is supplied permanently attached to dispenser head.
Assemble the tube to the connector on pump by pushing it on (provided on end of black tube).
Insert the Com Plug into the Com Socket (See Step 6).

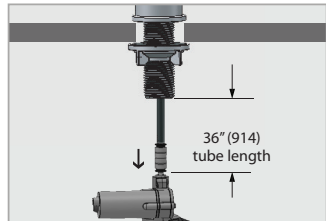

4

Fix the pump to the desired location by securing the support with the supplied screws.
For ease of installation preference, optionally swap steps 3 and 4 while ensuring pump is within reach range of Com cable.

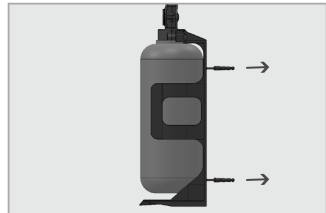

INSTALLATION

CONNECTING THE POWER SOURCE

5

Remove the protective sticker covering the sensor. Keep away from the sensor range.



6

Connect the Com Cable motor connector to the mating plug from dispenser (If not already connected in Step 3 above). Please note that since the connector is water proof, some friction will apply.

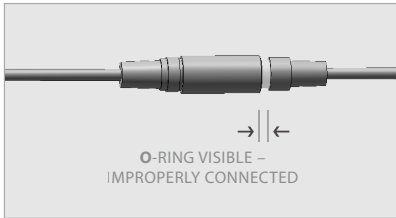

Important: the 4 contacts connector should be inserted fully so that the white **O**-ring is not visible and a clicking sound is heard.

NOTICE: If the 4 contacts connectors are not connected properly, the motor will run continuously.

INSTALLATION

CONNECTING THE POWER SOURCE

a. For battery versions: install the battery box at the wall underneath the sink and connect the battery connector.

Ensure adequate clearance to allow removal of the top cover and the battery carrier tray when battery change is required.

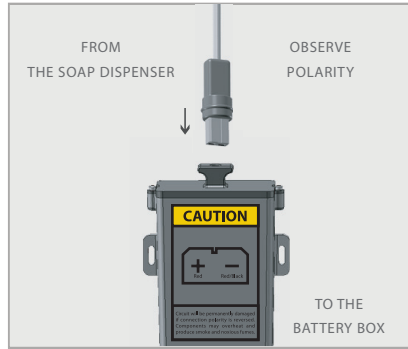

9

b. For AC Adapter versions: plug the adapter into the power socket and connect the adapter DC connector.

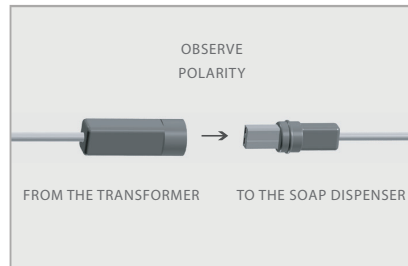

FILLING THE SOAP BOTTLE AND PRIMING THE SOAP DISPENSER

STEP 1 - FILLING THE SOAP BOTTLE

1

Remove the soap bottle from the EZFILL™ soap dispenser bracket and pour liquid soap into container until it is full. Refer to 'Technical Data' section of this manual for soap specifications. (Page 5)



2

Should any soap spill over the outside of the bottle, clean it thoroughly. Replace clean soap bottle into original position in the EZFILL™ soap dispenser bracket.

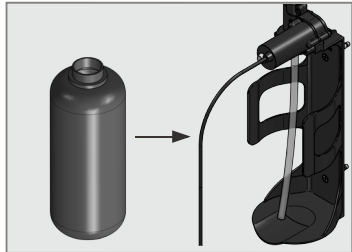

STEP 2 - PRIMING THE SOAP DISPENSER

1

Press and hold the fill button located on the EZFILL™ soap dispenser pump assembly until soap starts dispensing from the spout.

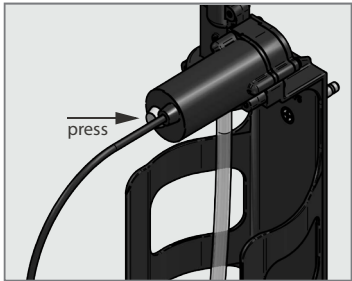

2

Optionally press (once) the fill function on the soap dispenser remote control while pointing LED at sensor. See SETTINGS ADJUSTMENT in 0390-R operation manual.

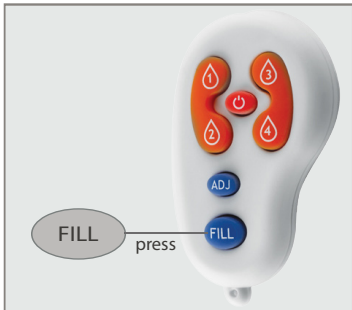

BATTERY REPLACEMENT INFORMATION

Battery models only

When the batteries weaken, the red indicator light will blink at a constant rate when the user's hands are within the sensor range. The batteries must be replaced within two weeks.

To replace the batteries:

1. Carefully open the battery box, use Phillips drive #2 to remove cover screws (Fig. 1&2, below)
2. Remove the old batteries from carrier tray (Fig. 3)
3. Replace the used batteries with new D batteries in same polarity (Fig. 3)

NOTE: Do not mix used batteries with new ones.

4. Close the box and re-tighten the screws (Fig. 4) and reconnect battery cable.

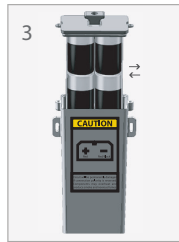

Important: Spent batteries should not be discarded with normal household waste. Contact your local authority for information on waste disposal and recycling.



MAINTENANCE

Care and cleaning of chrome and special finishes- see also PCM document.

DO NOT use steel wool or cleansing agents containing alcohol, acid, abrasives, or the like. Use of any cleaning or maintenance products containing these substances could damage the surface of the soap dispenser. For surface cleaning use **ONLY** soap and water, then wipe dry with a clean cloth or towel. When cleaning bathroom tiles or counters, protect the soap dispenser from any splattering of harsh cleansers.

TROUBLESHOOTING

PROBLEM	INDICATOR	CAUSE	SOLUTION
SOAP QUANTITY DIMINISHED	Low volume dispense	Voltage of batteries is low	Replace batteries
NO SOAP COMING OUT OF THE SPOUT	Red light in the sensor flashes continuously when the user's hands are within the sensor range.	Voltage of batteries likely below 1.47V per cell.	Replace batteries. See page 10.
	No soap dispensed.	Soap level is below supply tube.	Refer to page 9 and refill the soap bottle.
		The soap tank has been filled but soap has not reached the spout.	Press the refill button on the pump until soap starts to come out of the spout again, or press remote "Fill" button.
		The connector between the motor and the dispenser head is not properly engaged.	Connect the Com Cable plug and socket properly so that the white O-ring is not visible. Refer to page 7 instructions.
NO SOAP COMING OUT OF THE SPOUT		Sensor is picking up reflections from the washbasin or another object.	Eliminate cause of reflection.
	Red light in the sensor does not flash (once) when user's hands are within the sensor range.	Connectors between the dispenser head and the pump assembly and/or the power supply are disconnected or not properly connected.	Connect the plugs and sockets correctly.
		Batteries are completely depleted.	Replace batteries. See page 10.
SOAP DISPENSING FROM THE SPOUT CONTINUOUSLY	Red light flashes (once) and the motor operates.	Soap solidification at the supply tube.	Fill the tank with warm water at 120~140°F (49-60°C) and run the pump constantly until soap is dispensed.
	Steady stream of droplets is dispensing.	The Com Cable between the pump assembly and soap dispenser is not connected properly.	Connect the Com Cable plug and socket properly so that the white O-ring is not visible. Refer to page 7 instructions.

SPARE PARTS LIST

EZFILL™ Battery Pack	0390-BP
EZFILL™ Battery Pack (0390-BP) Extension Cable/1M Male to Female Connectors	0390-EBC
EZFILL™ Remote	0390-R
EZFILL™ 1-Liter Plastic Bottle	0391-SB

WARRANTY

We are pleased to offer this warranty covering ASI products furnished for your project.

This warranty replaces any other warranties or product descriptions, whether expressed or implied, written or oral.

It is understood that the products for this project have been selected and inspected by the purchaser, and have been accepted without qualification by the purchaser as merchantable, fit for the intended use, and satisfy the specifications.

THESE ASI PRODUCTS ARE WARRANTED TO BE FREE OF DEFECTS IN MATERIAL OR WORKMANSHIP FOR A PERIOD OF ONE (1) YEAR FROM DATE OF INVOICE.

BABY CHANGING STATIONS, IF INCLUDED ON THIS PROJECT, ARE WARRANTED TO BE FREE OF DEFECTS IN MATERIAL OR WORKMANSHIP FOR A PERIOD OF FIVE (5) YEARS FROM DATE OF INVOICE.

MIRRORS, IF INCLUDED ON THIS PROJECT, ARE WARRANTED AGAINST SILVER SPOILAGE UNDER NORMAL INDOOR ATMOSPHERIC CONDITIONS FOR A PERIOD OF FIFTEEN (15) YEARS FROM DATE OF INVOICE.

DRYER MODELS IF INCLUDED ON THIS PROJECT ARE WARRANTED TO BE FREE OF DEFECTS IN MATERIAL OR WORKMANSHIP FOR A PERIOD BETWEEN FIVE (5) AND TEN (10) YEARS, FROM DATE OF INVOICE. PLEASE REFER TO INDIVIDUAL TECHNICAL DATA SHEET FOR DRYER WARRANTY.

EZ FILL™ SOAP DISPENSER WILL BE FREE OF DEFECTS IN MATERIAL AND WORKMANSHIP DURING NORMAL USE FOR (2) TWO YEARS FROM THE DATE OF INVOICE.

Should the product fail under this warranty, the sole remedy, at the seller's option, will be to repair the defective product, refund the purchase price, provide an equivalent new or refurbished product or provide parts only.

ASI AND/OR SELLER DISCLAIM ANY LIABILITY FOR SPECIAL, INCIDENTAL OR CONSEQUENTIAL DAMAGES. This warranty excludes product damage due to incorrect installation, improper maintenance, wear and tear, battery spoilage, product abuse, or product misuse, whether performed by a contractor, service company, or the consumer.

ASI will not be responsible for labor costs associated with the removal, replacement, repair by others, reinstallation, renovation or return of its products.

Model 0390-R



EZFILL™ REMOTE CONTROL

REMOTE CONTROL FOR ALL MODELS
0390-(n) AND 0391-(n) AUTOMATIC
VANITY MOUNTED SOAP DISPENSERS

INSTALLATION AND MAINTENANCE GUIDE

OPERATION

If desired, use the remote control to adjust the soap dispenser settings. Hold the remote control straight in front of the sensor at a distance of about 4-6" (10-15cm).

User Hint: Holding the soap dispenser remote control out of the recommended range (too close or too far) may interfere with the remote's activation.

Choose the function you want to adjust by pressing on the function button as follows:*

1- SOAP VOLUME

The 1-4 drop keys allow the owner to control the desired soap dispense volume.



.004 to .013 oz
(0.2 to 0.4 ml)



.023 to .030 oz
(0.7 to 0.9 ml)



.041 to .054 oz
(1.2 to 1.6 ml)



.071 to .078 oz
(2.1 to 2.3 ml)

Confirmation: continuous blink of the red light in the sensor eye.

*The exact soap dispense volume depends on the soap viscosity. Factory setting is 0.03 oz (0.8 ml).

2- ADJ

This function allows reverting to soap dispense volume factory setting.

Confirmation: 2 blinks of the red light in the sensor eye.

3- TEMPORARY OFF FUNCTIONS

This function is ideal to perform any kind of activity in front of the sensor without operating the system (for example, cleaning). The soap dispenser will remain off for one (1) minute when this button is pressed once.

To cancel this function and to return to normal operation press the On/Off button again or wait one (1) minute.

Confirmation: OFF – 2 fast blinks, ON – 4 fast blinks

4- STARTING SOAP LINE AFTER REFILLING SOAP TANK

Once the soap tank has been filled \ re-filled, press the FILL button. The pump will run for one (1) minute to allow the soap to start coming out of the soap dispenser spout.

To stop this activity press the FILL button again. If the soap has not started coming out of the spout, check for leaks and / or kinked or blocked or disconnected tubing. If all ok, then press the FILL button again.

Repeat as necessary.

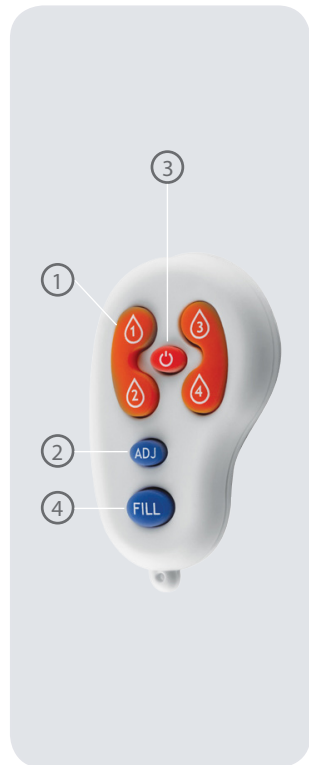

ASI[®]

