

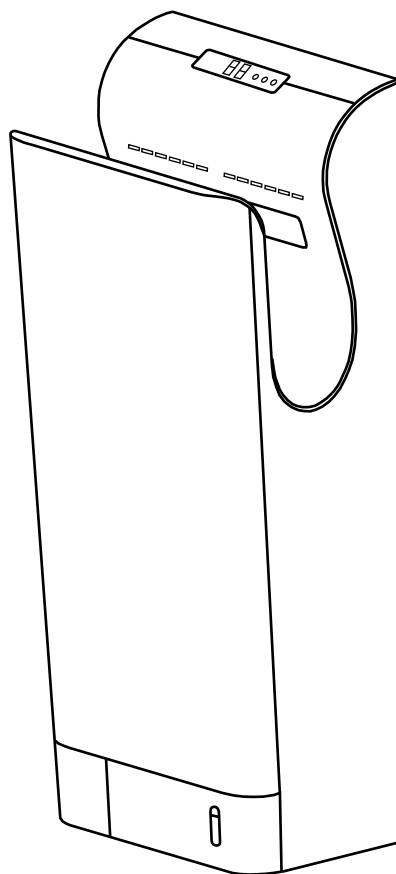

Electric Hand dryer

Installation and operating manual



- Do not attempt to install the unit yourself unless you are a trained service technician. Otherwise, this may affect safety and proper functioning of the unit.
- Read this manual thoroughly and carefully before using the unit to ensure safety and proper function. Keep this manual for later reference

Contents



Contents, Features, Specifications	1
Warning.	2
Parts, Dimensions explained	3
Usage.	4
Routine cleaning.	5
Troubleshooting, Electrical schematic	6
Before installing the hand dryer	7
Installation	8-9
Test run	9
Packing list	10

Features

- Hygienic contact-free hand drying solution
- High speed hand drying ensures low energy consumption
- Efficient design, easy to use
- Anti-damage timer for safe use
- Does not require use of towels or tissues; is waste-free
- Made of anti-bacterial and environmentally friendly material
- Automatic heater for comfortable warm hand drying in winter & cool hand drying regime in summer
- Equipped with a filter for automatic sterilization (HEPA filter)

Anti-damage timer

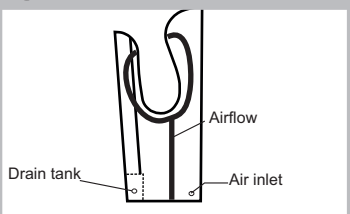
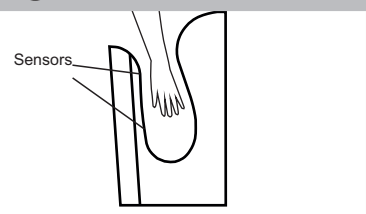
An anti-damage timer enables this machine to automatically stop working after 25 seconds. When this happens and if you wish to continue using the machine, take your hands out and insert them again into the dryer; the unit will start working automatically.

1 No add. windpipe	2 Sensors	3 Designed in accordance with human engineering
 <ul style="list-style-type: none"> Isolated hygienic air supply equipped with water dripping prevention mechanism 	 <ul style="list-style-type: none"> No spatter 	 <ul style="list-style-type: none"> Easy to use

Specification

Rated voltage	AC 220-240V~ 50/60 Hz	Motor	Brushless DC motor
Power without heater	650-800W	Protection class	IPX4
Power with heater	1650-2050W	Dimensions	300x212x700mm
Wind velocity	95m/s	Net weight	11KGS



WARNING

Improper use increases risk of personal injury!



Prohibited



Do not use in the bathtub or shower room



Do not allow the unit to get wet.



Prohibit disassembling



Comply with instructions



Ground



WARNING



- Do not open the front panel, otherwise this may result in an electric shock
- Children must not hang on the unit to avoid the risk of falling
- Do not use in a wet environment, for example near the bathroom where the unit may get wet and places with forming condensation, otherwise this may result in an electric shock and unit malfunction
- To avoid the risk of an electric shock, keep the unit dry at all times
- Do not modify and disassemble the unit unnecessarily. Otherwise this may cause a fire, an electric shock, or personal injury
- Rated power is required
- If power tolerance is over $\pm 10\%$ there will be breakdown. Using incorrect power supply can cause fire, an electric shock and machine malfunction
- Use dedicated sockets only. Sharing a socket with other appliances may cause overheating and start a fire
- Power must be cut off during maintenance to prevent the risk of an electric shock
- Drain tank and air filter must be installed. Do not turn on the unit for 10 seconds after plugging it in
- If the unit doesn't work or exhibits abnormalities, cut off power to prevent accidents, close leakage circuit breaker and ask supplier to check and repair, or it may lead to a fire because of electricity leakage and short circuit
- The unit must be supplied with a reliable growing wire to avoid the risk of an electric shock in case of a failure or a leak
- Attention when installing the unit: do not install while the unit is plugged in
- Installation must be performed by a professional construction worker. Incorrect installation can cause an electric shock and a fire accident
- The unit is not intended for use by persons (including children) with reduced physical, sensory or mental capabilities or lack of experience and knowledge, unless they have been given supervision or instruction concerning the use of the unit by a person responsible for their safety. If the cord is damaged, it must be replaced by the manufacturer, its service agent or similarly a qualified person in order to avoid a hazard. For additional protection, the installation of a residual current device (RCD) having a rated residual operating current not exceeding 30mA is advisable in the electrical circuit supplying the bathroom, ask your installer for advice.
- **Environmental hazard**
Electrical waste should not be disposed of together with household waste. Recycle where facilities exist, check with your local authority or retailer for recycling advice.



Parts and dimensions specifications

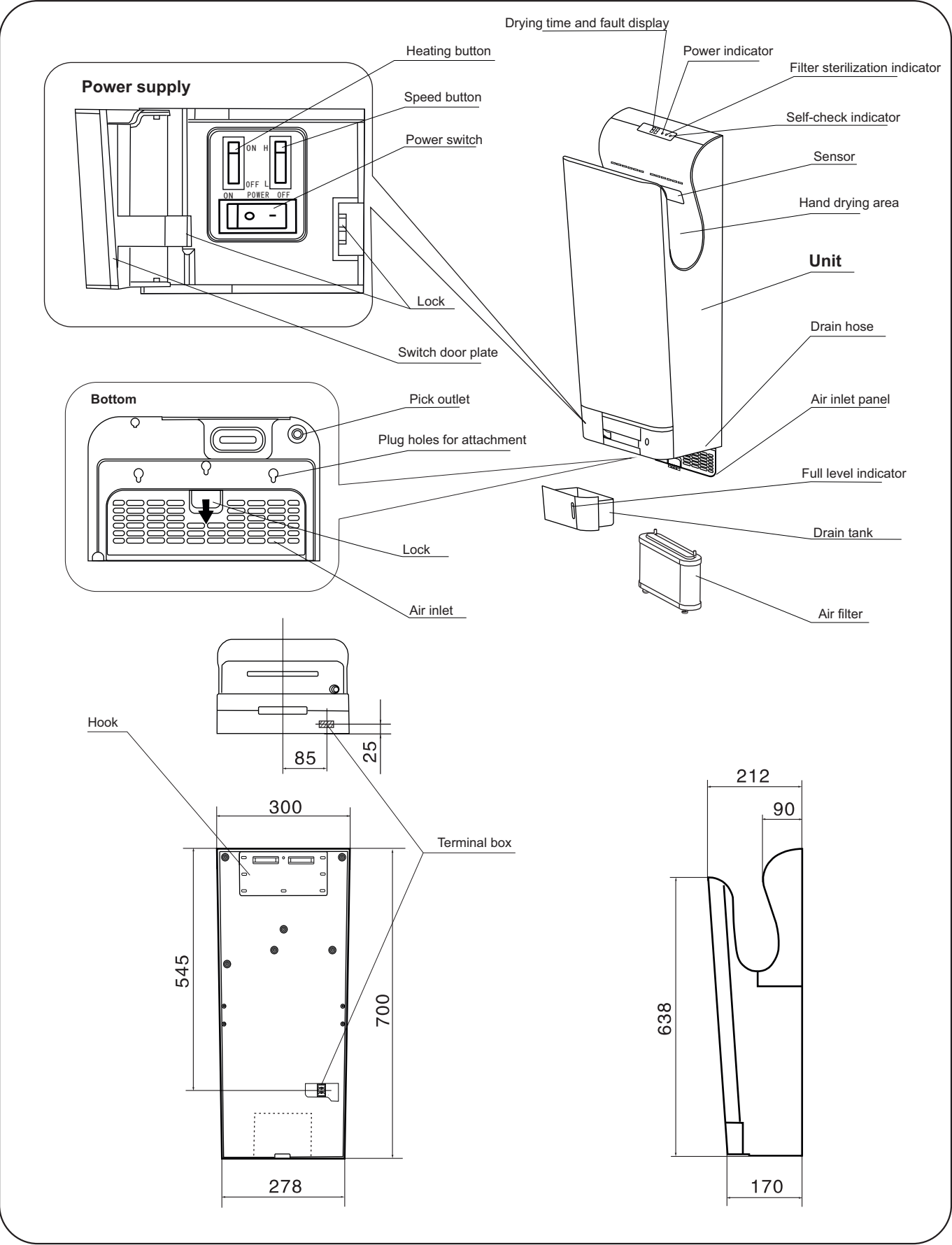

■ How to use

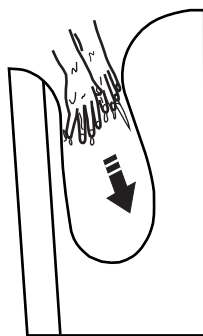

- Stretch both hands out and insert all the way in. The unit will start automatically.

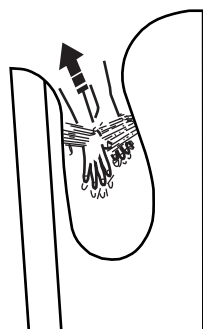

- Withdraw hands slowly, letting the air blow residual.

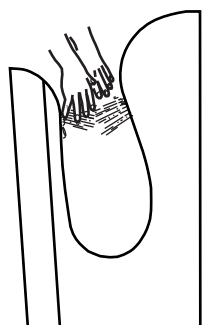

- Pull hands out entirely.

◆ When using the unit

Turn on the power switch, when

- the power indicator lights up
- the lamp lights up
- the lid of power supply is closed

Usage label

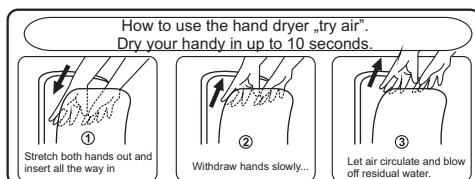

Place the usage label on a visible spot (*on the front of the unit or on the wall next to the unit*).

Routine cleaning

Cleaning the unit

Before the unit gets obviously dirty

- If the unit is very dirty, clean with a soft cloth dampened with neutral agents, then clean with a dry soft cloth.
- Remove dirt from the sensor (to prevent malfunction).



Note!

- Only use neutral cleaning agents.
- Do not use thinners, acidic or alkaline toilet cleaners, or a nylon brush, (*otherwise they may damage the smoothness of surface*) Use only alcohol to clean hand drying area (*do not use alcohol anywhere else on the unit*).
※ Alcohol = alcohol used for disinfection (with concentration below 83%.)
- Application of disinfectants will damage your unit.



WARNING



- Before cleaning the unit, turn off the power switch.
- Do not splatter water on the unit.



CAUTION

- Wear gloves when cleaning the unit.

- The unit's antibacterial coating is effective when the bacteria are exposed to the coated surfaces.
- The antibacterial coating loses its properties when surfaces get very dirty.

Draining and cleaning the drain tank

Clean the tank before it fills up (at least once a week)

- The water blown off the hands in called "drain water".
- Empty the drain water at any moment to prevent accumulated water from exceeding the maximum allowed capacity.
- The tank will start emitting unpleasant odors if the accumulated water remains in the tank for too long.

1

Pull the drain tank out horizontally so as not to spill the drain water.

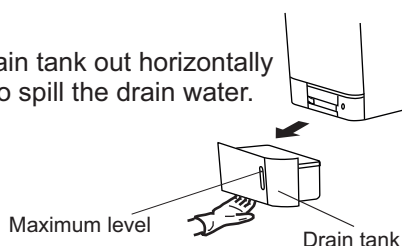

1

Remove the air filter

- Open the air inlet panel and pull out the air filter by the handle

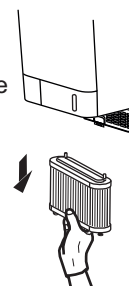

2

1. Open the lid and empty the water.

- Pull the lid up with your fingers on both sides, remove the cover.

2. Wash out the interior of the drain tank.

3. Put the lid back on and reattach the tank to the unit.

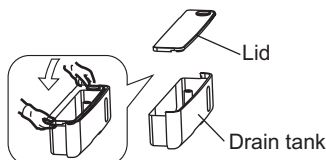

2

1. Cleaning the air filter

- Remove the dust using a vacuum cleaner, a hairbrush or emptying it on the surface



2. Reattach to the unit

- Insert the filter all the way in.
If the filter is installed incorrectly or is absent, dirt or dust will penetrate the unit and shorten its service life.



Note!

- Do not wash air filter with water or any other liquid!

3

Run 200cc (around 1 cup) of water through the drain hole to prevent it from getting clogged.

- Use the unit after making sure the water tank is reattached correctly.

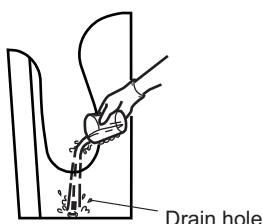

Trouble shooting, Electrical schematic

If the following situation occurs, follow the guidelines to resolve the problem.

Problem	Check	Action
No air blows even if hands are inserted.	<ul style="list-style-type: none"> Are indicators correctly displayed? Is the power on? Are you inserting your hands all the way in? 	<ul style="list-style-type: none"> Turn the ground-fault circuit breaker on. Turn the power switch on. Insert hands all the way in.
The unit continues working when hands withdrawn, then shows E2 status.	<ul style="list-style-type: none"> Any dirt or foreign object on the sensor? 	<ul style="list-style-type: none"> Turn the unit off by switching off the power button, remove dirt or foreign objects on the sensor after the power light has gone out. When finished, switch on the unit by turning on the power button.
No hot wind.	<ul style="list-style-type: none"> Is the heater switched on? Any dirt on the sensor? Is the fuse inside the terminal box blown? 	<ul style="list-style-type: none"> Is the ambient temperature higher than 20°C? Turn the unit off, remove the front lid, and locate a terminal box inside. Take down the lid of the terminal box. Inspect the fuse inside the box.
Airflow is too low.	<ul style="list-style-type: none"> Is the speed button set on low? 	<ul style="list-style-type: none"> Adjust airflow speed by setting the speed button higher.

If the above actions do not work, turn off the unit and the ground-fault circuit breaker, and call your dealer to inspect and repair the unit if necessary (*costs are as per agreement with the dealer*).

Electrical schematics

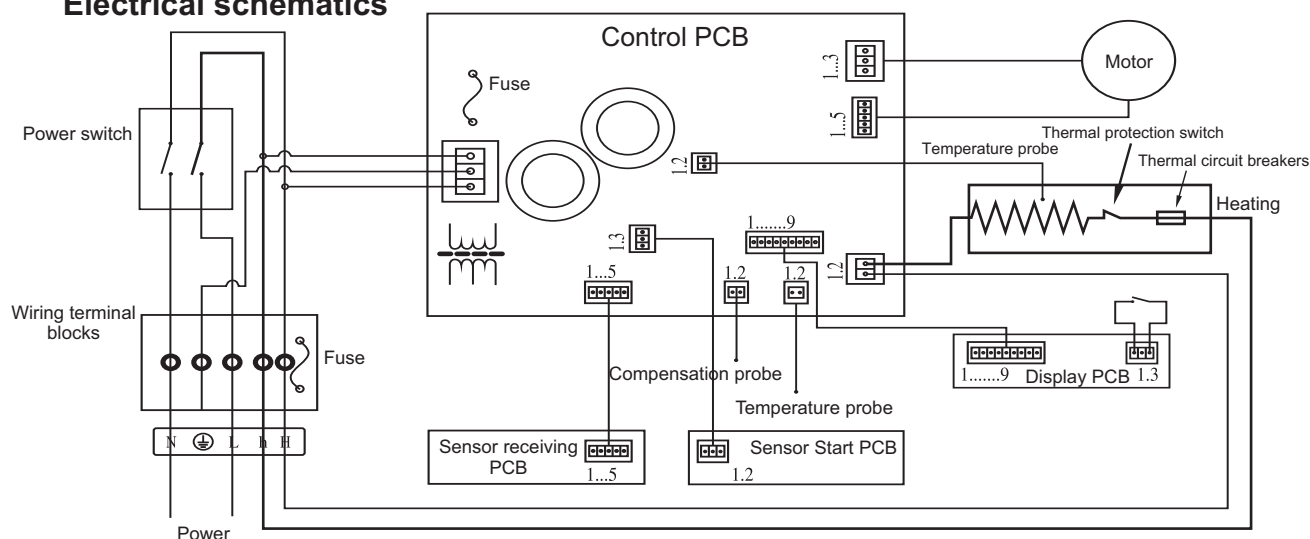

	Status	Introductions	Status	Introductions	Solution
Power Indicator light	Light	Power input normal	Extinguish	No power supply	Check external power source. Turn off power.
State Indicator light	Extinguish	Don't work	Flashing light	Motor fault, it cannot start normally	Inspect connecting wires and motor for presence of debris.
	Always light	Working		Trick or working time longer than 25s	Clear workspace from all foreign material, restart the unit.
Timing digital tube	Digital changes	Countdown work	Jump display	Drying circle completion indicator	
	E1	The unit won't start normally. Motor failure.	E2	Trick or working time longer than 25 seconds.	Clear workspace from all foreign material, restart the unit.
	E3	The voltage exceeds 15%	E4	The voltage lower than 15%	Check the power supply circuit.
	E5	Machine temperatures higher than 80 °C	E6	Master board temperatures higher than 80 °C.	Clear the air inlet and air outlet from debris.
			E8	Fan failure.	Check whether the fan sensor wire is loosened.

Before installing the hand dryer

■ Do not install the unit in the following types of environment, otherwise this may cause malfunction:

- Locations where temperatures can exceed -10 °C or 40 °C
- Locations where the unit may come into direct contact with water
- Locations where the unit is under direct or strong sunlight
- Locations with high humidity levels
- Locations where corrosive, neutral, or reductive gases are present in the air
- Locations higher than 2,000m above the sea level

■ Installation location

- Install the hand dryer in a location where it will be easy to use, and ensure that there is adequate space around the dryer for cleaning and maintenance.
- If the unit is installed too low, water may splash onto the dryer when the floor is being cleaned. *(The bottom of the hand dryer must be mounted at least 150mm above the floor).*
- Avoid installing the hand dryer in locations where people or doors might bump into the dryer.
- Choose a completely flat surface on the wall to install the dryer.

■ Network connectivity

- It is recommended to connect the unit sideways next to the socket on the wall. The socket should not appear under the unit so as to guarantee easy access to the unit's filter.
- Direct connection to a flush device box.

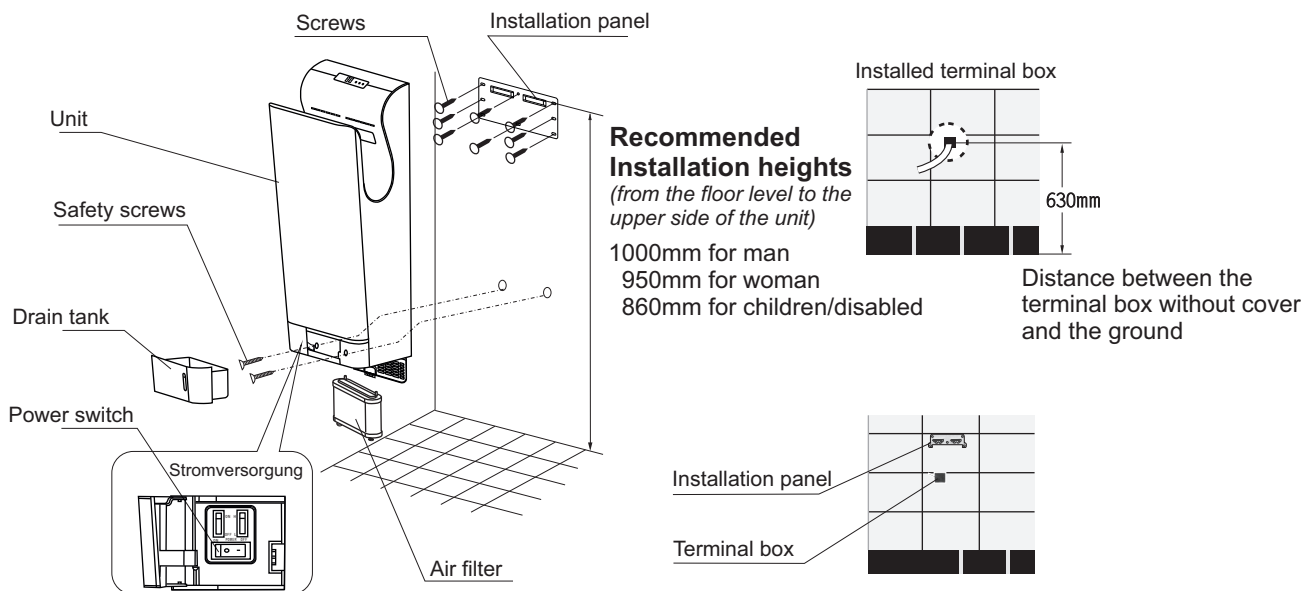

Installation procedure

- Pay attention to the correct power supply (*single-phase*). Deviations can lead to failure.
- Use only suitable cable from the specialized trade for the electrical installation.
(If you have no experience in the field, so please contact a qualified installer)

1

Wire the unit

Connect the power cord to the cables from the flush-mounted box.

- In order to ensure a flush and secure wall mounting, neither socket cover neither socket cover nor other obstacles may impede proper assembly

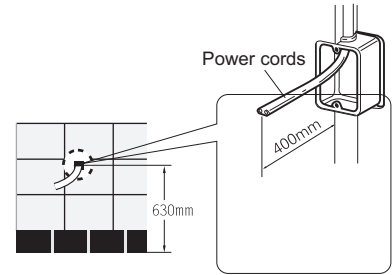

2

Fix the mounting plate on the wall with the provided screws

- Use appropriate dowels according to the nature of the substrate (concrete, masonry, etc.)
- Make sure that the wall is stable enough for the assembly.
- Attach the drilling template to the wall and drill the holes.
- Place dowels into the holes and firmly fasten the mounting plate with screws.

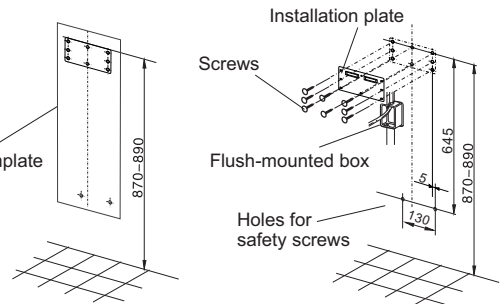

3

1. Prepare the electrical installation

If the unit is plugged in, follow steps 6 and 7.

- If the unit is connected to electricity with the wire, first pull out the electric cover and power cords

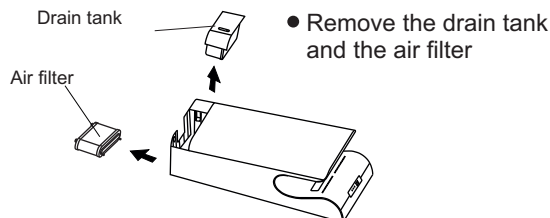

2. Removal of electric cover and power cords

- (1) Unscrew the 2 screws on the electric cover, open the cover.
- (2) Unscrew the 2 screws on the power cord clamp, loosen the 3 screws on the terminal box, then pull out the power wire.

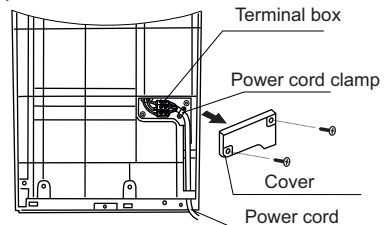

4

Connecting separate power cables into the unit

The device is already provided with a 1.5 m long power cable.
If you want to use a different cable, follow the procedure as described below:

- Lift the unit up to a comfortable working height (250-300mm) and connect the unit as follows:
 - (1) Remove the insulation of the power cable
 - (2) Connect the power cable to the terminal block of the device
 - (3) Tighten the screws in the terminal block and make sure that the cable is firmly seated.
 - (4) Secure the power cord with the power cord clamp!

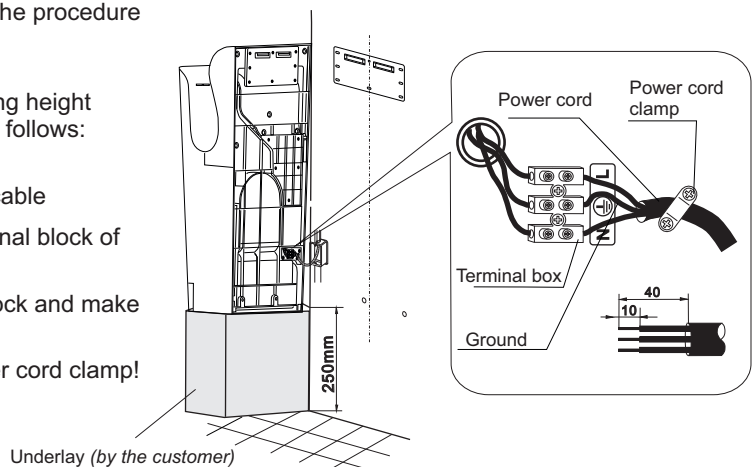

WARNING: Risk of electric shock

Installation Procedure

5

Install the terminal block cover

- (1) Put the terminal block cover on the terminal block and fix it with installation screws.
- (2) Make sure that the power cable has enough room and the lid is mounted flat.

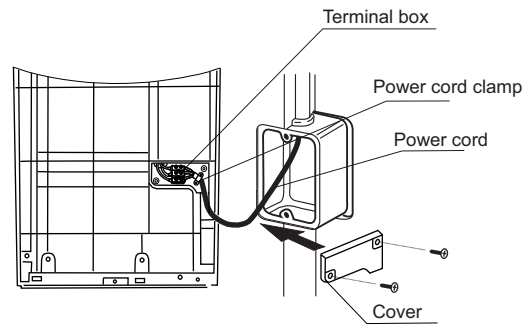

6

Fix the unit

- (1) Tidy the power lines and press excess cords into the terminal block on the wall
- (2) Place the hook on the back of the unit into the hanging trough of the installation panel, make sure the unit is stable, and close to the wall
- (3) Tighten the securing screws!

Note:

The safety screws provide additional protection against unwanted disassembly!

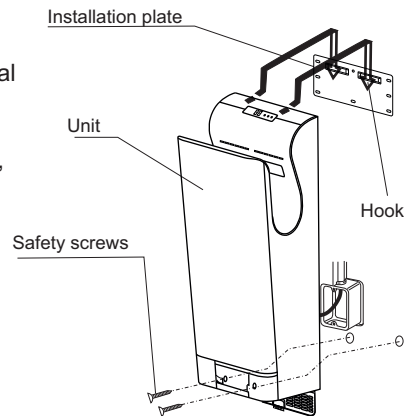

7

1. Insert the air filter

- Push the air filter up into the unit towards the end, then close the air inlet door and lock it.

2. Insert the drain tank

- Push the drain tank into the unit as shown in the diagram.

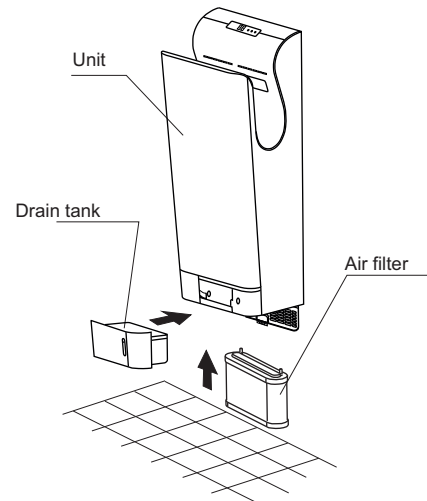

Test run

	Required steps	Check	Result
1	Check the voltage of power supply	Please use the rated voltage.	
2	Turn the ground-fault circuit breaker on		
3	Turn the power switch on*	Does the power indicator light up?	
4	Dry hands	Is the air blowing?	
5	Check the unit	Is the unit installed firmly? Any vibration or strange noise?	

* Do not turn the power switch on with your hands inside the unit!

Packing list

Unit	1
Installation plate	1
Installation dowels	10
Installation screws	10
Users manual	1
Application use	1
Drilling templates	1